

N99开合电机-NTY-说明书

公司保留更改产品设计与说明书的权利, 届时将不另行通知, 图片仅供参考, 具体以实物为准。

A/0 H12287

产品简介

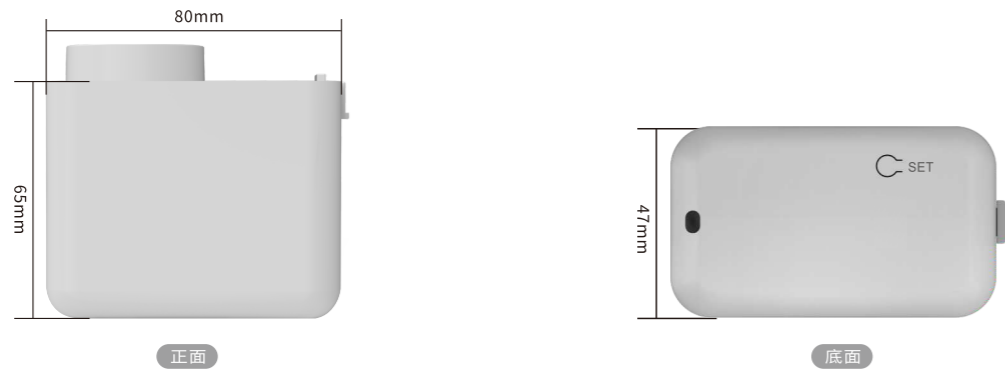

操作说明 (*以A13按键发射器为例进行说明, 其它发射器请参考相应的发射器说明书。)

对码: 重复操作对码步骤即是消除当前码。一台电机最多储存5个发射通道, 再新增发射器会循环覆盖前一个通道。



复制: 为已经对码的电机新增一个发射器:



换向: 切换已对上码电机运转方向。如: 换向前, 按发射器打开键, 窗帘关闭, 则需要换向设置:



设置行程:



行程取消:



恢复出厂设置: 清除电机上所有设置并恢复至默认状态



配网重置方法:

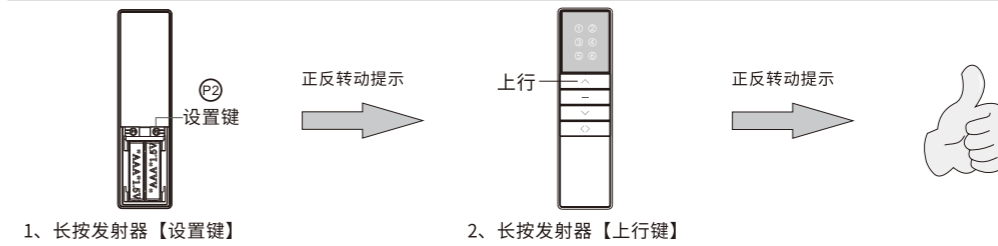

APP配网方法:

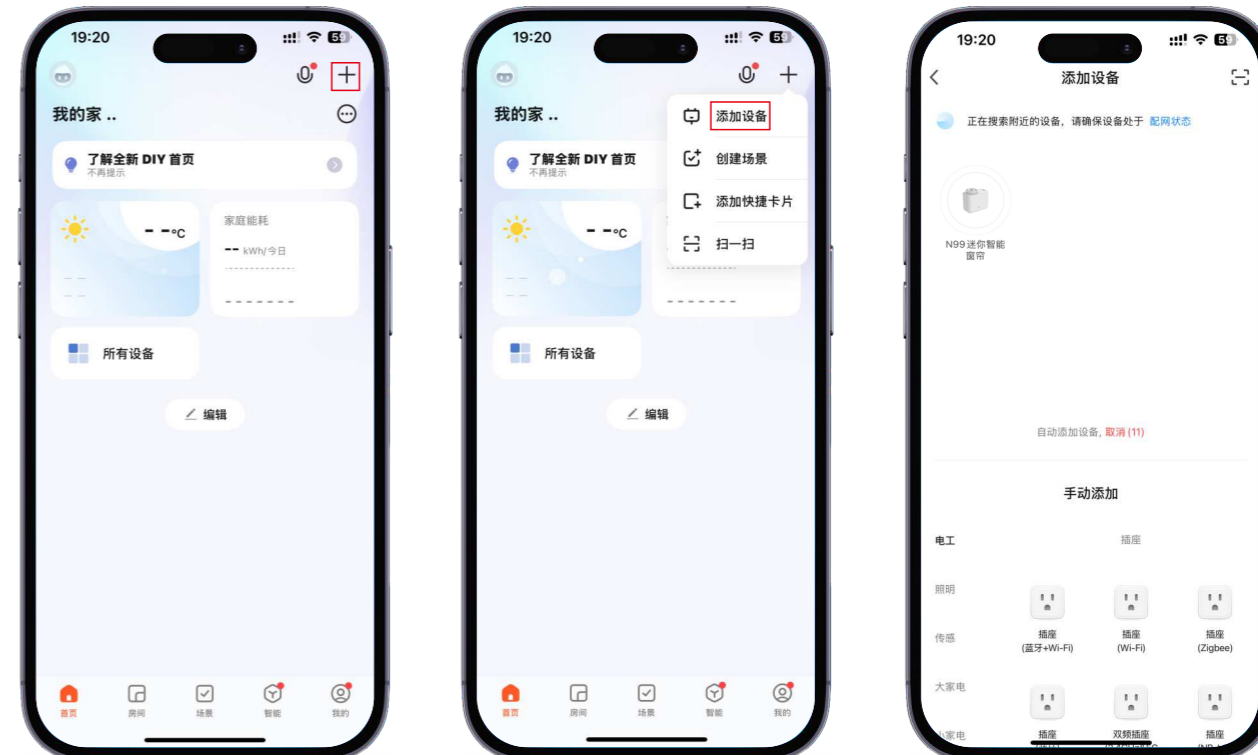

01.打开米家APP, 选择右上角的“+”
02.选择“添加设备”
03.出现电机图标后, 点击进行配对

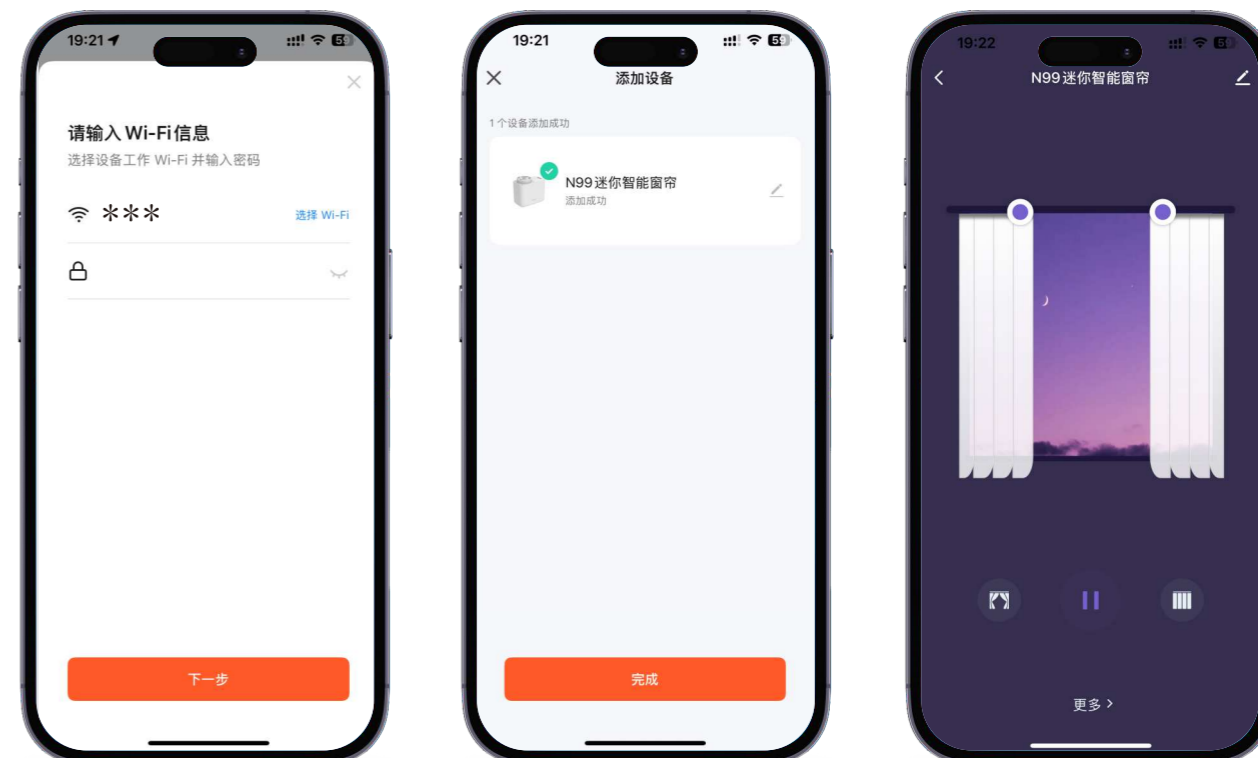

04.输入密码后点击下一步
05.添加成功, 点击完成
06.最终操作界面如上图所示

N99-3E curtain motor manual-NTY

Company reserves the right to change product design and specifications without prior notice then ,photos are for reference only.

A/0 H12287

Product Introduction

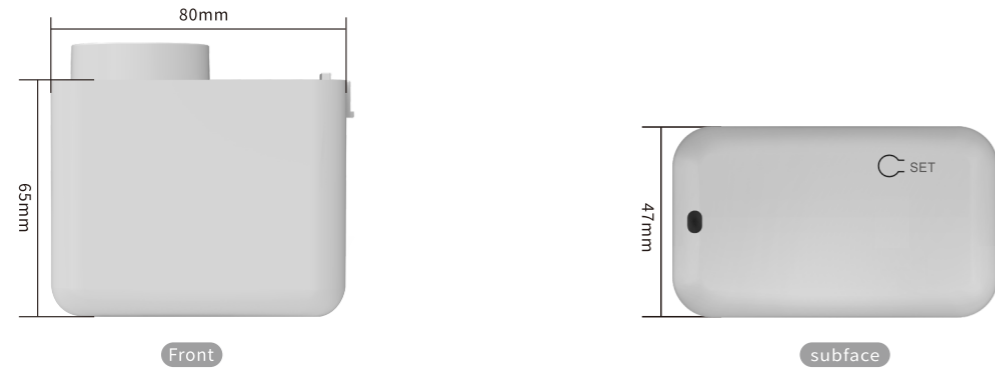

Instructions: (Take A13 button transmitter as an example, for other transmitters, please refer to the corresponding transmitter manual.)

Pairing transmitter and motor repeat the pairing operation once to eliminate the current pairing. A motor stores up to 5 transmitter channels, adding a new transmitter channel will cover the earliest channel. For example, current paired channels are 1-5. If you add channel 6, paired channels will be 2-6.

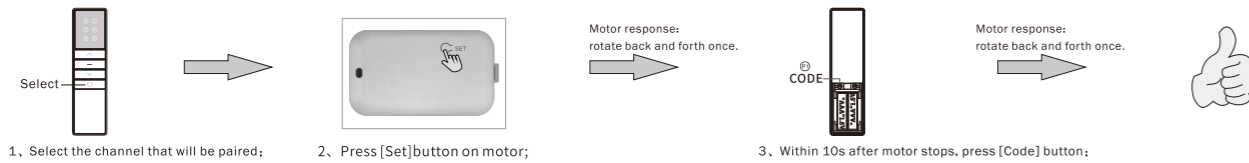

copy add a new channel to control motor. (No need to touch motor)

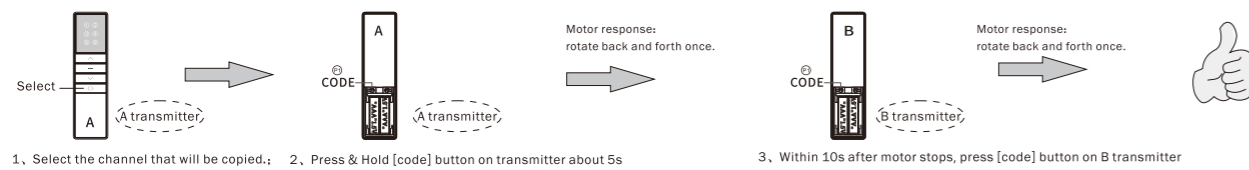

Reset direction Reset motor direction. Such as: before reset, press transmitter up button, blinds runs down. After reset, press transmitter up button, blinds runs up.

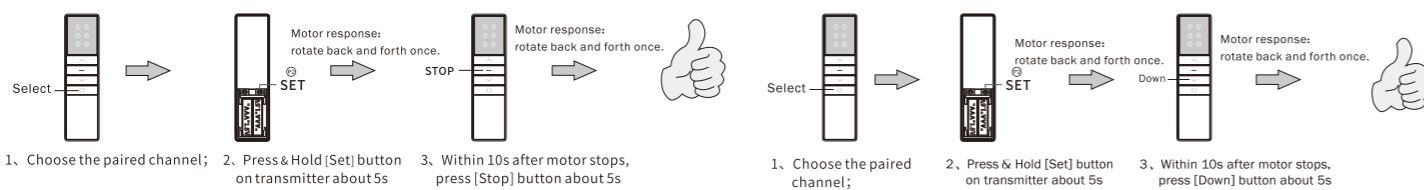

Limit Setting

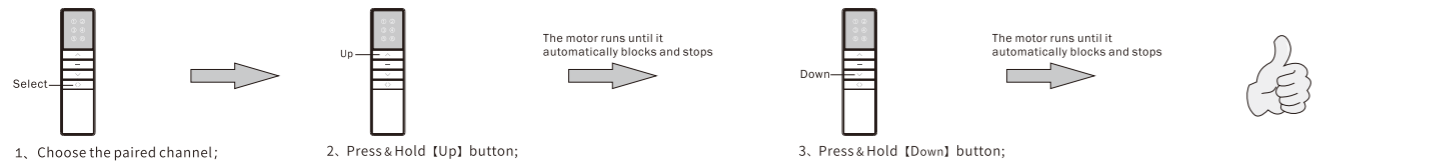

Cancel limit

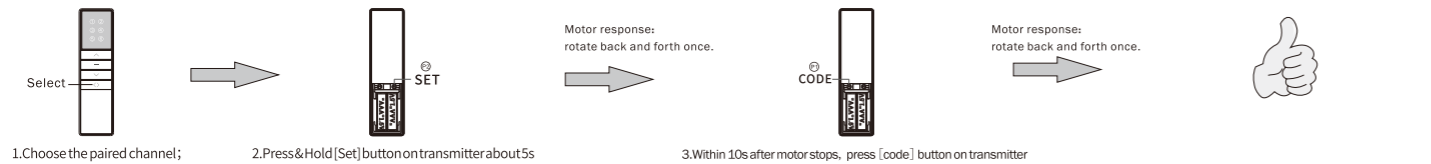

Restore factory settings clear all settings on the motor and restore to the default state



Reset Wi-Fi:

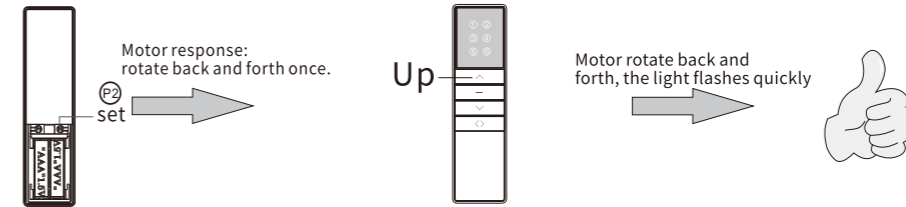

1. Press & Hold [Set] button

2. Press & hold [Up] button

Configure network method:

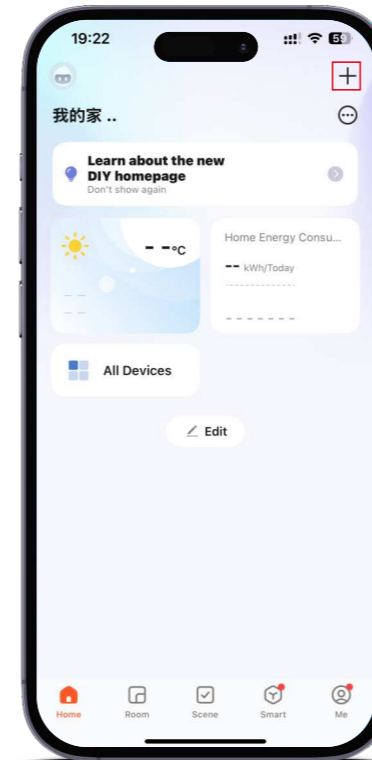

01.Open Mijia App, click “+”

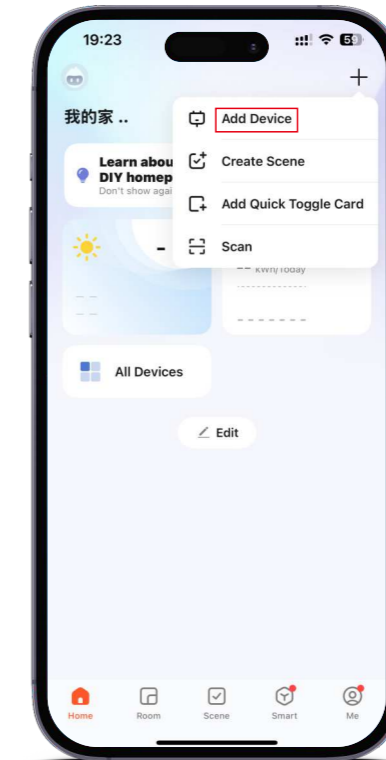

02.Click “Add Device”

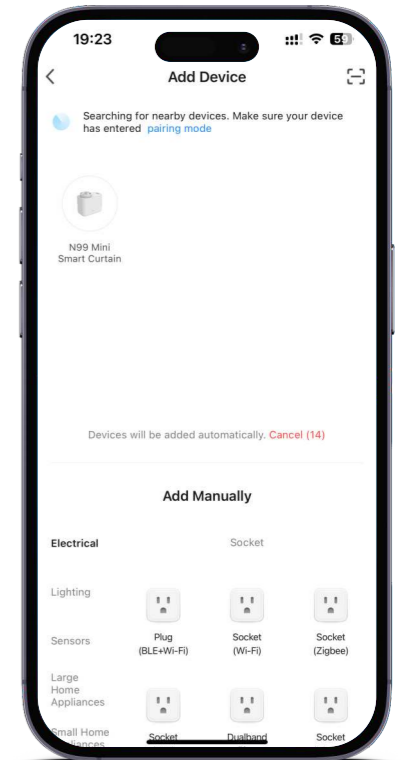

03.Click “N99 Mini Smart Curtain”

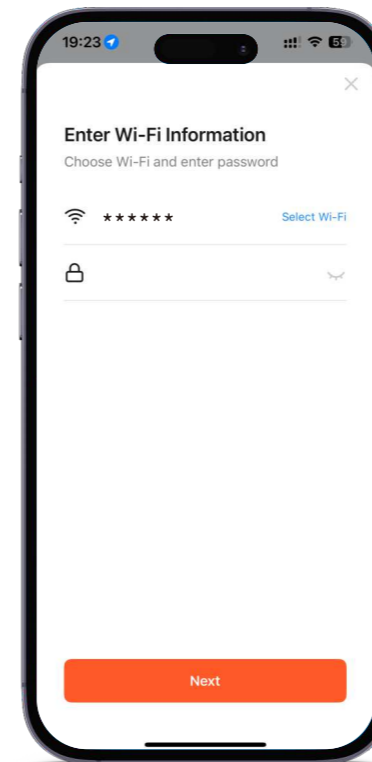

04.Enter the WiFi information and click "Next" after completion

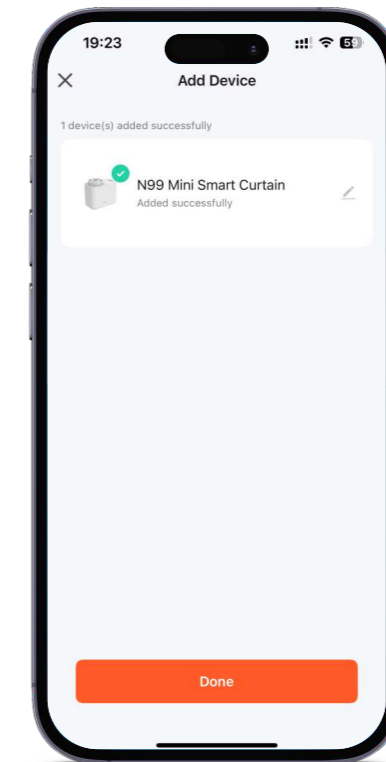

05.After added successfully, click “Done”

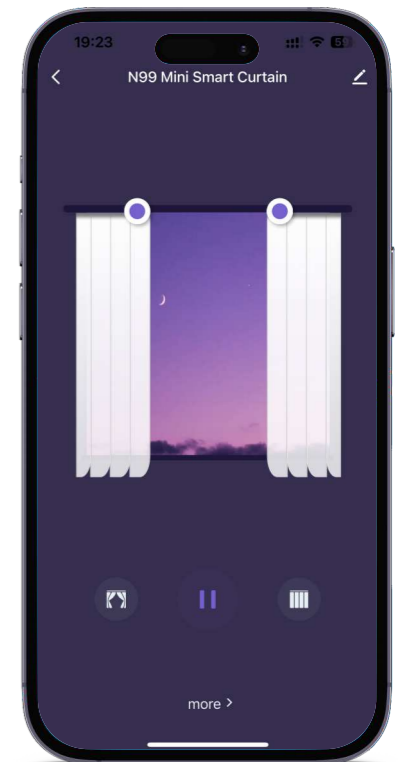

06.Operation interface