

E24-4E Skylight Motor II Operating Manual

Company reserves the right to change product design and specifications without prior notice then, photos are for reference only.

A/O H12183

Features

1. Input voltage: DC5V 2A
2. Can be charged with mobile phone charger
3. Can be charged with solar panel (as shown on right)
4. The indicator light is always on when charging and turns off when fully charged.
5. When the battery is low, a beep beep beep will sound.



charged with solar panel



System diagram

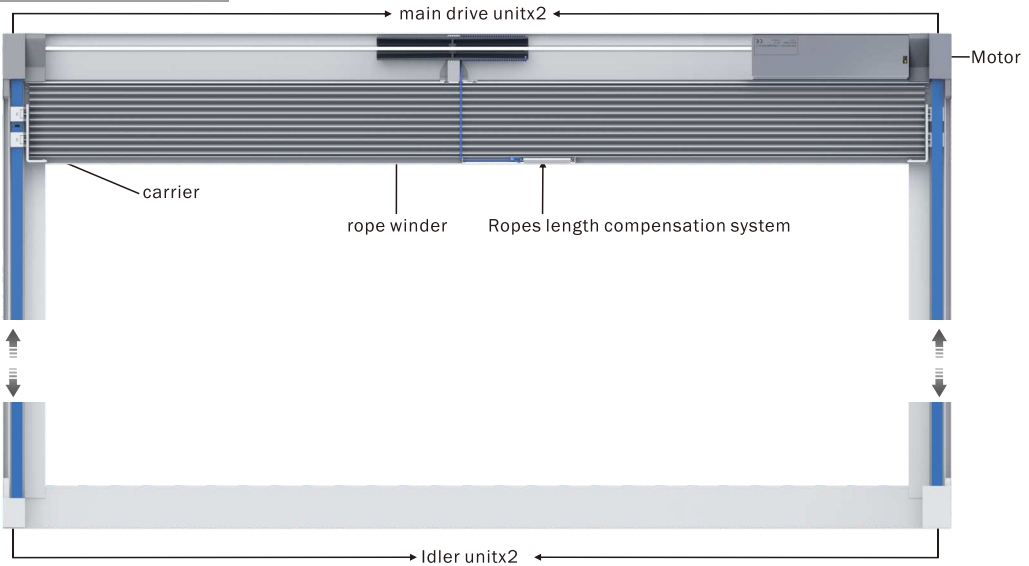

I Instructions (*Take A13 button transmitter as an example. For other transmitters, please refer to the corresponding transmitter manual.)

Pairing transmitter and motor :

Repeat the pairing operation once to eliminate the current pairing. A motor stores up to 5 transmitter channels. Adding a new transmitter channel will cover the earliest channel. For example, current paired channels are 1-5. If you add channel 6, paired channels will be 2-6. :

1. Select the channel that will be paired ;
2. Press **[Set]** button on motor ;
3. Within 10s after motor stops, press **[P1]** button;

Motor response:
rotate back and forth once.

Motor response:
rotate back and forth once.



Clear pairing : Clear all pairing on the motor :

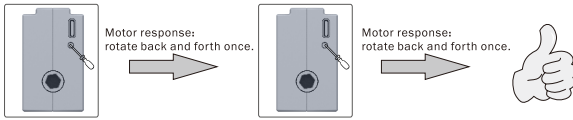

1. Press & Hold **[Set]** button on motor about 10s ;
2. Press **[Set]** button on motor again;

Inching / Continuous moving interchange : Default is continuous moving. After switching to inching moving, press & hold **[Up]** or **[Down]** button about 2s, motor will continuously moves;

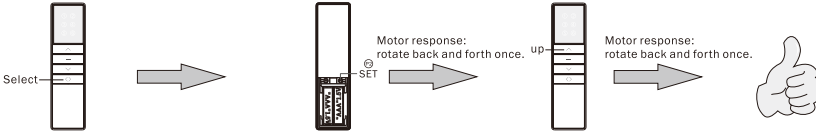

1. Select the paired channel ;
2. Press & Hold **[P2]** button on transmitter about 10s ;
3. Within 10s after motor stops, press **[Up]** button about 5s ;

Copy : Add a new channel to control motor. (No need to touch motor);

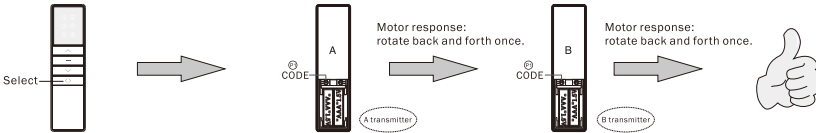

1. Select the paired channel ;
2. Press & Hold **[P1]** button on transmitter about 10s
3. Within 10s after motor stops, pair on the new channel ;

Reset direction : Reset motor direction. Such as: before reset, press transmitter up button, blinds run down. After reset, press transmitter up button, blinds run up.

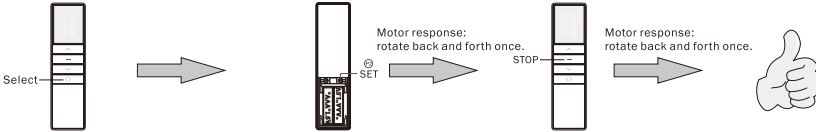

1. Select the paired channel ;
2. Press & Hold **[P2]** button on transmitter about 10s;
3. Within 10s after motor stops, press **[Stop]** button about 5s;

Limit Setting :

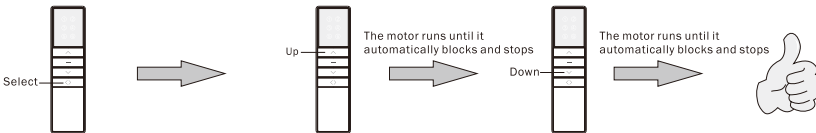

1. Select the paired channel ;
2. Press & Hold **[Up]** button;
3. Press & Hold **[Down]** button;

Precise limit : there is a gap in the default limit position, and it can be set to no gap.

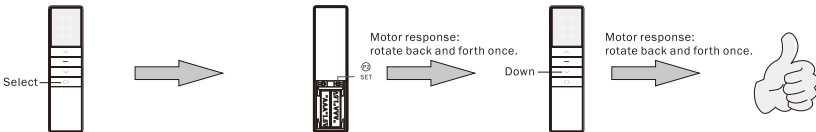

1. Select the paired channel ;
2. Press & Hold **[P2]** button;
3. Press & Hold **[Down]** button;

Delete limit : Mode1: When there is limit, and when motor is blocked and stopped once during operation, the limit will be deleted.

Speed setting : Two speed can be adjusted, Default is first;

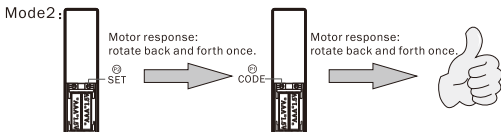

1. Press & Hold **[P2]** button on transmitter about 5s;
2. Press & Hold **[P1]** button on transmitter

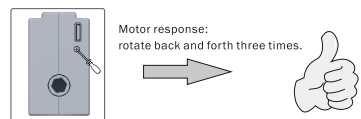

1. Press & Hold **[Set]** button on motor about 15s ;