

N17/N18 Curtain motor & Track system manual

Company reserves the right to change product design and specifications without prior notice then ,photos are for reference only. H12114 A/1

B Bearing Capacity Parameter Table

Units: (Kg) Remark: Double Single
Here by we recommend the formula to calculate the fabric weight as follows: fabric weight=fabric weight Kg/ m² x fabric area covered m² x wrinkles rate.

2N,m single motor	Track style		Loading weight							
	Fabric length									
4m	60	50	R500	R500	R500	R500	R3000	R3000		
8m	55	45	45	40	35	30	25	21	16	
12m	50	40	35	30	25	20				

Description: 1. The chart shows the maximum load bearing of 2N. m single motor with different track settings (length/opening way, etc.).
When calculating the maximum load bearing, the fabric wrinkle rate should also be taken into account.
2. In the chart, the maximum load bearing does not consider the friction between fabric and track or curtain box.

C Curtain Motor Structural Drawing

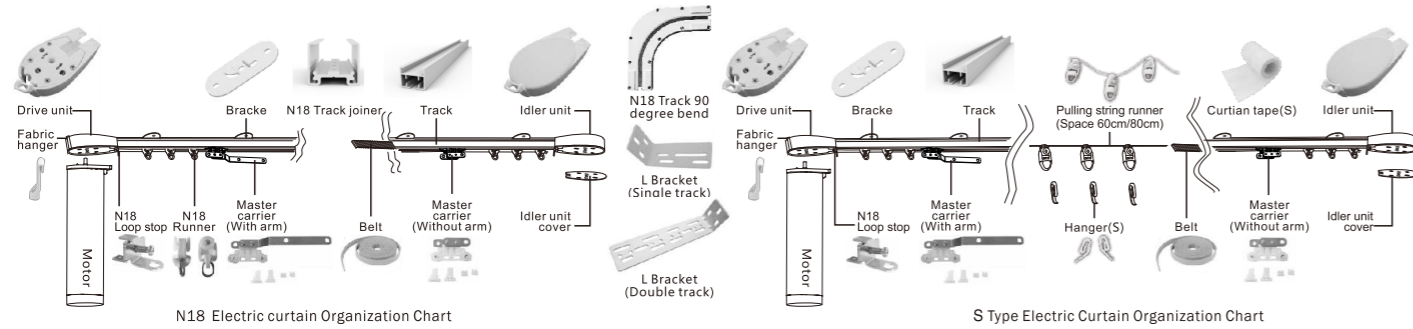

T The track system the assembly instruction

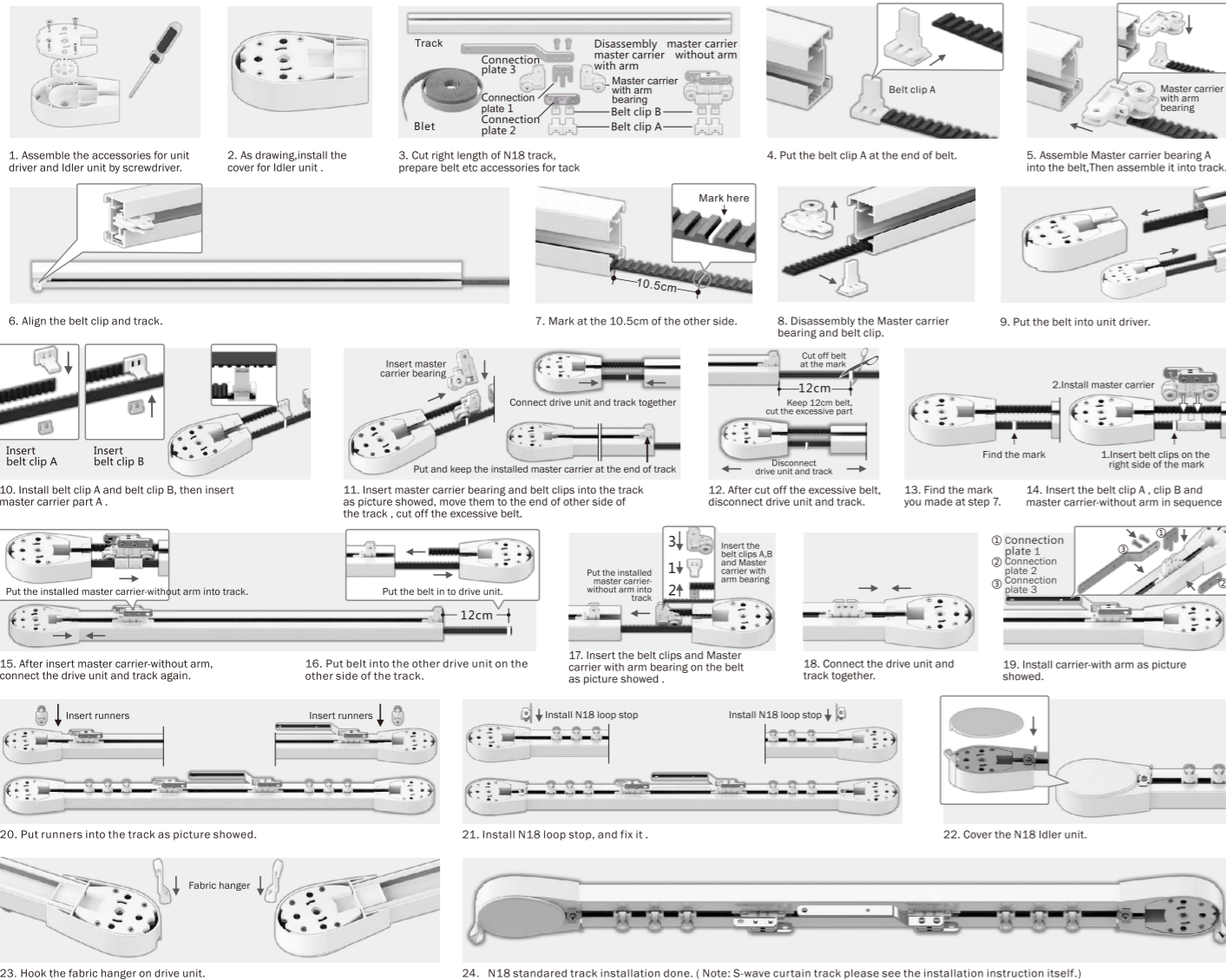

I Installation and dis assembly of track and motor

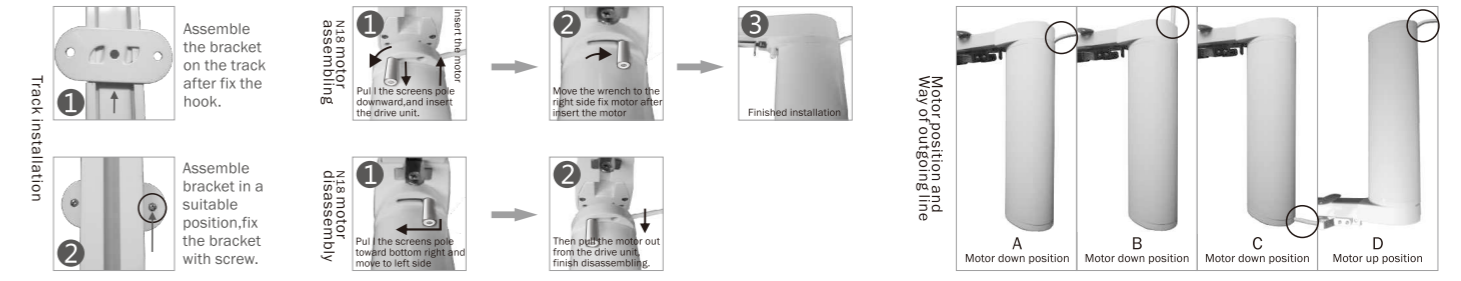

T Terminal switch wiring method

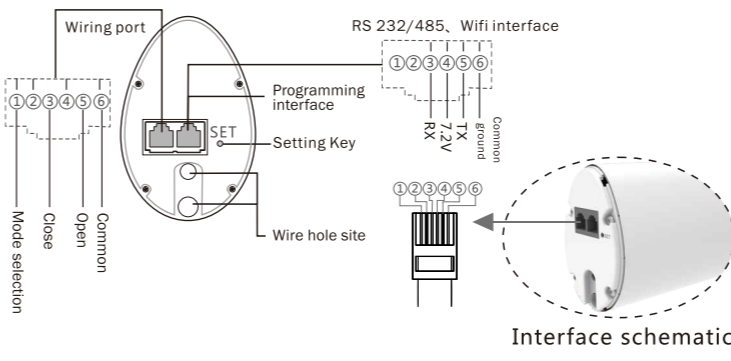

L Low voltage mode selection

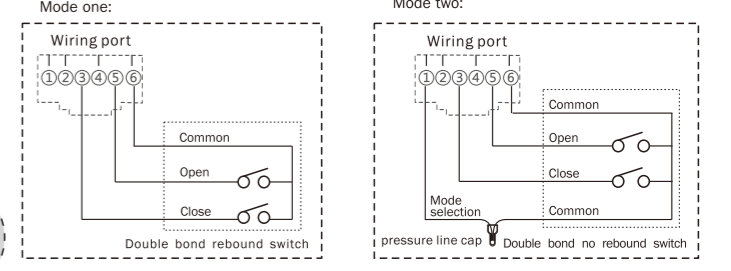

A AC power switch installation wiring diagram

⚠ ① Strong current control distance more than 60m, the need for special custom.
② Zero line and Fire wire can not be reversed. If there is a spare line after wiring, please use pressure line cap to do well insulation.

AC power switch double-key mode five-wire connection method:

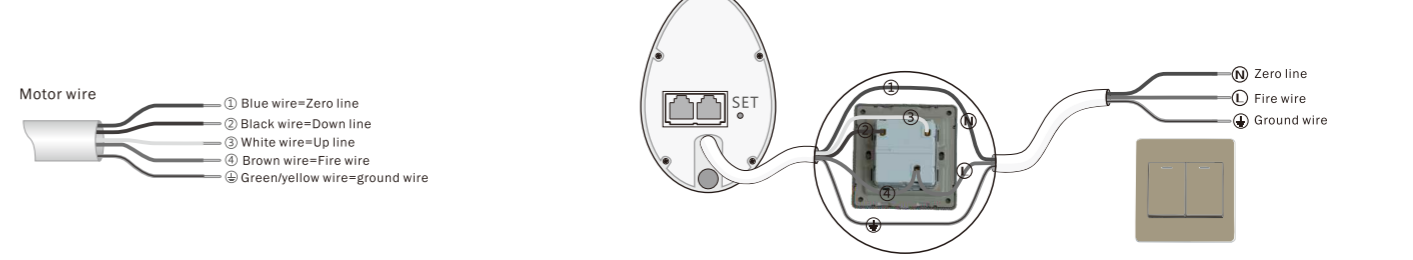

AC power switch double-key mode four-wire connection method:

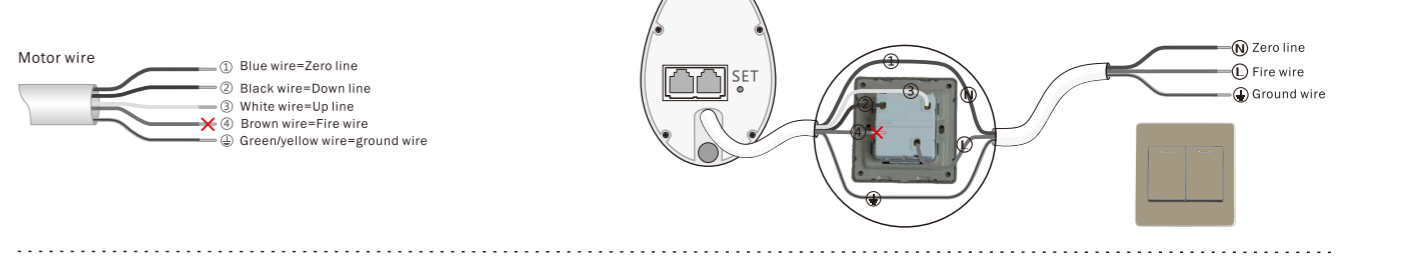

AC power switch hotel mode connection method:

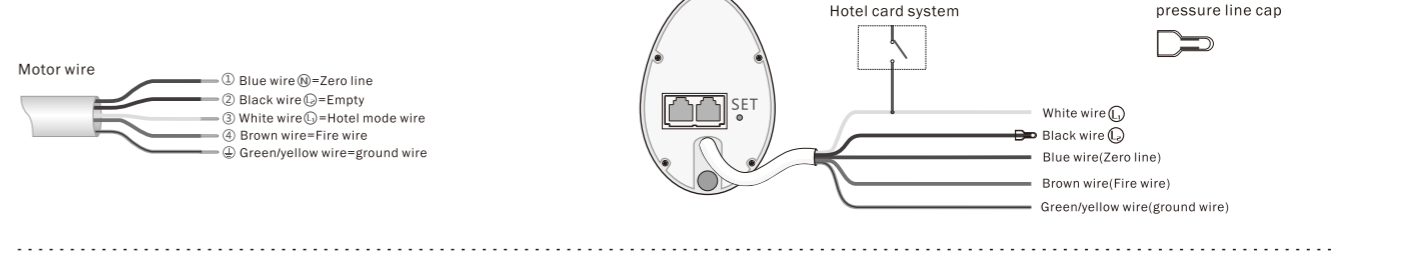

Three-wire conventional wiring method:

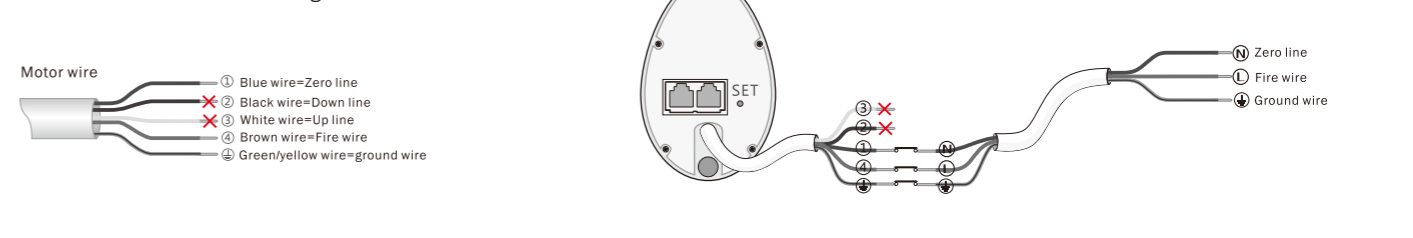

I Instructions (*Take A3 button transmitter as an example. For other transmitters, please refer to the corresponding transmitter manual.)

Open the motor cover: Open the motor cover before you operate

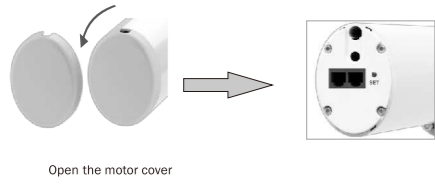

Open the motor cover

Pairing transmitter and motor : Repeat the pairing operation once to eliminate the current pairing. A motor stores up to 10 transmitter channels. Adding a new transmitter channel will cover the earliest channel. For example, current paired channels are 1-10. If you add channel 11, paired channels will be 2-11.

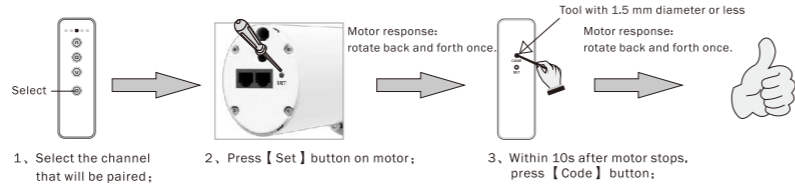

Delete code: Delete the code with transmitter
Delete all code.

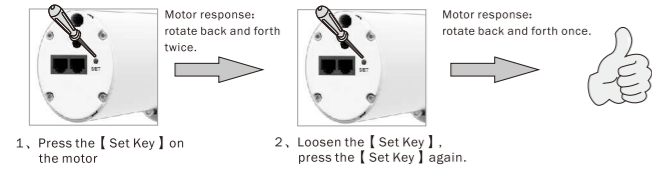

Speed setting : Two speed can be adjusted, Default is first;

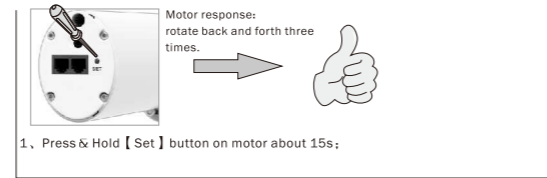

Eliminate limit : N17-4E and 5 wires curtain motor have this features: Eliminate limit as way 1 or way 2:

Way 1 :

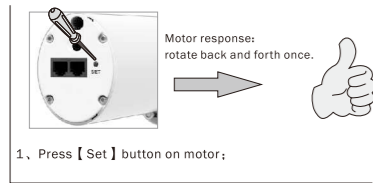

Way 2 :

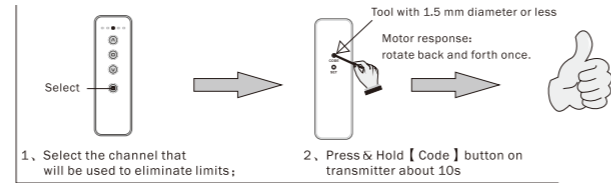

Reset direction : Reset motor direction. Such as: before reset, press transmitter up button, blinds run down. After reset, press transmitter up button, blinds run up.

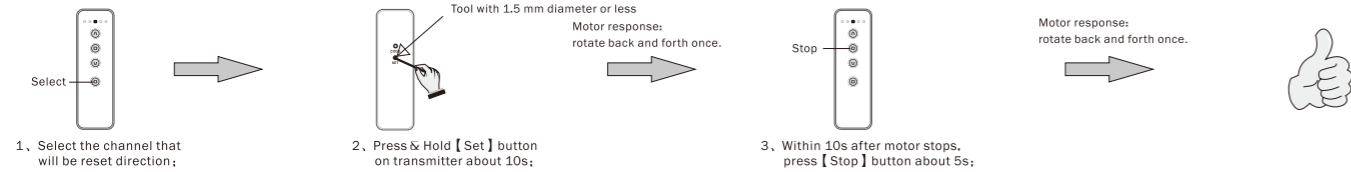

Copy : Add a new channel to control motor. (No need to touch motor);

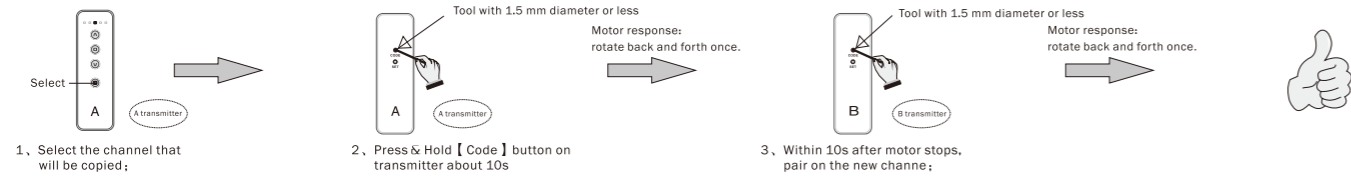

Hand pull distance setting : The default hand pull distance is 5cm and can be set to 15cm.

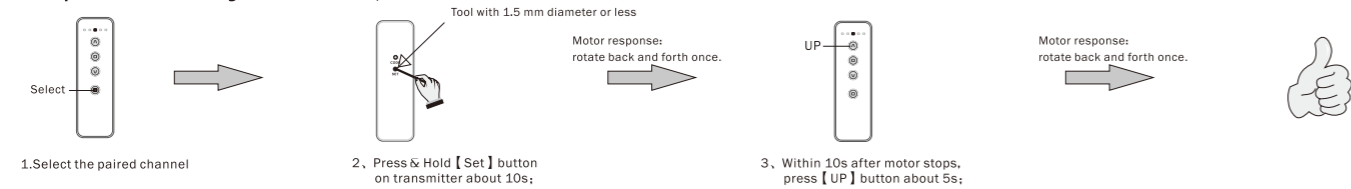

A AC power switch mode selection ⚠ The factory default is the first mode.

